

Refinish Catalog

**ANEST
IWATA**



Car Painted by Armando Serrano



**Spray Guns
& Accessories**

ANEST IWATA SPRAY GUN EQUIPMENT



ANEST IWATA is the North American subsidiary of ANEST IWATA Corporation in Japan, a leading manufacturer specializing in painting equipment, turnkey coating systems, air compressors and high-end dry vacuum pumps.

As part of the world-class operation we strive to exceed the highly advanced needs of North American industries with innovative, state-of-the-art technologies and services.

As the sole importer of ANEST IWATA finishing equipment into the North American market specializing in painting equipment and turnkey coating systems we continue to introduce and produce the most effective finishing equipment in the world.



Anest Iwata products are sold exclusively through Automotive Spray Equipment Technologies, LLC.



Model	WS400 EVOTECH	W400-LV	LS400 ENTECH	LPH400- LV/LVB/LVX	LPH300
	suitable for	suitable for	suitable for	suitable for	suitable for
Clear Coat	X	X	X	X	
Base Coat	OBS NOZZLE	X	X	X	
Primer Sealer		X			X
Primer Surfacer					X
Small Damage Repair					

ANEST IWATA SPRAY GUN EQUIPMENT

High Transfer Efficient Spray Technology

Our patented LV Technology nozzle design features higher fluid delivery that facilitates faster, smoother application. The result is higher transfer efficiency rate, resulting in greater material savings.



LV Technology Spray Nozzle



0 PSI

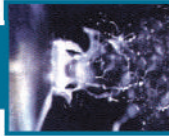

0.7 PSI

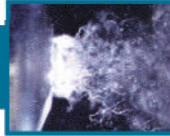

1.5 PSI

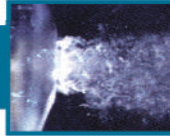

2.9 PSI

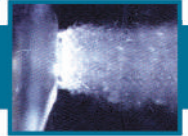

4.4 PSI



Non-LV Spray Nozzle

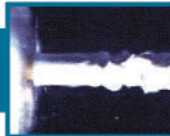
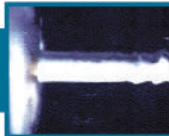
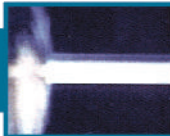

Model	LPH101-LV	LPH200-LV	LPH-80	RG3L	LPH-50	AZ3 HVLP-S IMPACT
	suitable for	suitable for	suitable for	suitable for	suitable for	suitable for
Clear Coat						
Base Coat						
Primer Sealer						X
Primer Surfacer	X	X				X
Small Damage Repair			X	X	X	

COMPLIANT SPRAY GUNS

evotech[®]

with optional plastic gravity feed cup



SUPERNOVA WS400 EVOTECH

Features

- EPA NESHAP 40 CFR, part 63 subpart 6H compliant
- Large, uniform spray pattern
- Concentrated fine atomization
- Large fan tulip pattern
- Very fine atomization
- Standard for clear coats
- Fast application speed
- Superior transfer efficiency
- Compatible with the 3M PPS cup system (Adapter Type 43)
- Repair Service Kit Part #5652

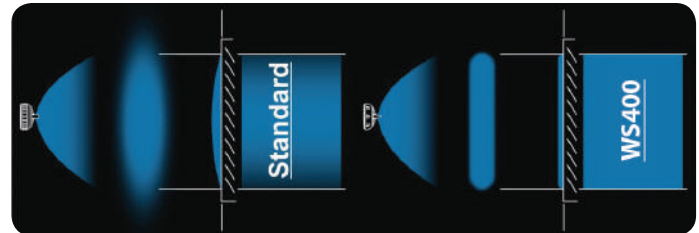

The SUPERNOVA delivers a consistent droplet size when atomizing. This, combined with the flat, even SUPERNOVA pattern, helps reduce common application issues. All SUPERNOVA guns are equipped with stainless steel fluid passages ideal for any type of material, solventborne or waterborne.



600ml Plastic Cup
PCG600P-2 #6039



700ml Aluminum Cup
PCG7D-2 #6032D



1000ml Aluminum Cup
PCG10D-2 #6038D

MODEL	GUN ONLY	600ml PLASTIC CUP	700ml ALUMINUM CUP	1000ml ALUMINUM CUP	NOZZLE mm (inch)	PSI	CFM	FLUID OUTPUT ml/mm	PATTERN WIDTH mm (inch)	AIR CAP MODEL	WEIGHT g (lbs)
WS400-1201 HD	5900	5901	5902	5903	1.2 (0.047)	29	12.57	200	365 (14.38)	WS-400-01	423 (0.93)
WS400-OBS	5920	5921	5922	5923	1.3 (0.051)	29	12.57	160	365 (14.38)	WS-400-01	423 (0.93)
WS400-1301 HD	5905	5906	5907	5908	1.3 (0.051)	29	12.57	220	365 (14.38)	WS-400-01	423 (0.93)
WS400-1401 HD	5910	5911	5912	5913	1.4 (0.055)	29	12.57	240	370 (14.57)	WS-400-01	423 (0.93)
WS400-1501 HD	5915	5916	5917	5918	1.5 (0.059)	29	12.57	260	370 (14.57)	WS-400-01	423 (0.93)

COMPLIANT SPRAY GUNS

W400-LV CLASSIC PLUS SERIES

Features

- Center post gravity feed high transfer efficiency spray gun combines LV Technology with High-TEC standards
- Tulip inspired spray pattern complies with regulations for the application of coatings within specific areas and approval is subject to the conditions of your regional air quality agency
- ANEST IWATA W400-LV spray gun sold and distributed within the jurisdiction of regional air quality districts is subject to the local rule
- Compatible with the 3M PPS cup system (Adapter Type 2)
- Repair Service Kit Part #5650

Classic plus Series



600ml Plastic Cup
PCG6PM #6000



700ml Aluminum Cup
SST Fluid Joint
PCG7EM #6033E



1000ml Aluminum Cup
SST Fluid Joint
PCG10EM #6034E



with optional
aluminum
gravity feed cup



MODEL	GUN ONLY	600ml PLASTIC CUP	700ml ALUMINUM CUP	1000ml ALUMINUM CUP	NOZZLE mm (inch)	PSI	CFM	PATTERN WIDTH mm (inch)
W400LV-124G	4750	4751	4752	4753	1.2 (0.047)	20	10.0	249 (9.8)
Compliant with AK-1R2	4855	4856	4857	4858	1.2 (0.047)	20	10.0	249 (9.8)
W400LV-134G	4755	4756	4757	4758	1.3 (0.051)	20	10.0	269 (10.6)
Compliant with AK-1R2	4860	4861	4862	4863	1.3 (0.051)	20	10.0	269 (10.6)
W400LV-144G	4760	4761	4762	4763	1.4 (0.055)	20	10.0	290 (11.4)
Compliant with AK-1R2	4865	4866	4867	4868	1.4 (0.055)	20	10.0	290 (11.4)
W400LV-164G	4765	4766	4767	4768	1.6 (0.063)	20	10.0	305 (12.0)
Compliant with AK-1R2	4870	4871	4872	4873	1.6 (0.063)	20	10.0	305 (12.0)
W400LV-184G	4770	4771	4772	4773	1.8 (0.063)	20	10.0	325 (12.8)
Compliant with AK-1R2	4875	4876	4877	4878	1.8 (0.063)	20	10.0	325 (12.8)

HVLP SPRAY GUNS

entech

with optional plastic gravity feed cup



SUPERNOVA LS400 ENTECH

Features

- HVLP Technology - 10 PSI at the nozzle
- Concentrated coarse atomization
- Excellent for solvent or waterborne base coat application
- Large fan pattern
- Superior transfer efficiency
- Compatible with the 3M PPS cup system (Adapter Type 43)
- Repair Service Kit Part #5652

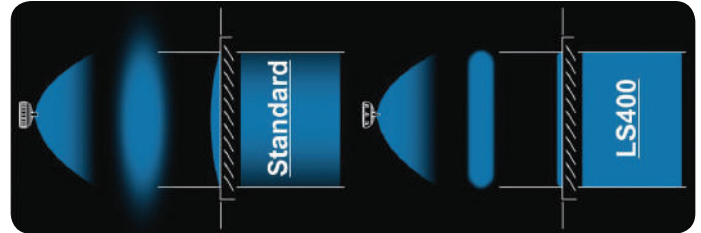

The SUPERNOVA delivers a consistent droplet size when atomizing. This, combined with the flat, even SUPERNOVA pattern, helps reduce common application issues. All SUPERNOVA guns are equipped with stainless steel fluid passages ideal for any type of material, solventborne or waterborne.



600ml Plastic Cup
PCG600P-2 #6039



700ml Aluminum Cup
PCG7D-2 #6032D



1000ml Aluminum Cup
PCG10D-2 #6038D

MODEL	GUN ONLY	600ml PLASTIC CUP	700ml ALUMINUM CUP	1000ml ALUMINUM CUP	NOZZLE mm (inch)	PSI	CFM	FLUID OUTPUT ml/mm	PATTERN WIDTH mm (inch)	AIR CAP MODEL GREEN (10psi)	WEIGHT g (lbs)
LS400-1205	5930	5931	5932	5933	1.2 (0.047)	26	14.12	150	350 (13.75)	LS-400-05	423 (0.93)
LS400-1305	5935	5936	5937	5938	1.3 (0.051)	26	14.12	160	350 (13.75)	LS-400-05	423 (0.93)
LS400-1405	5940	5941	5942	5943	1.4 (0.055)	26	14.12	170	360 (14.18)	LS-400-05	423 (0.93)
LS400-1505	5945	5946	5947	5948	1.5 (0.059)	26	14.12	180	365 (14.38)	LS-400-05	423 (0.93)

HVLP SPRAY GUNS

LPH400-LV / LPH400-LVB / LPH400-LVX CLASSIC PLUS SERIES

Features

- High material savings due to LV Technology
- Extremely low air requirement for a HVLP gun
- Pre-atomization technology with split nozzle
- Quality surface for easy cleaning
- Minimal wear parts for easy maintenance
- Compatible with the 3M PPS cup system (Adapter Type 2)
- Repair Service Kit Part #5650



L VX AIRCAP Patent Pending

LPH400-LVX

Designed to increase productivity for 90 to 95% of all basecoats.

L VB AIRCAP Patent Pending

LPH400-LVB

Designed with excellent metallic control for the most difficult basecoats.

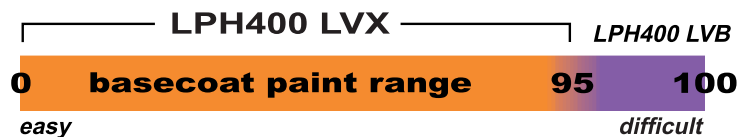

600ml Plastic Cup
PCG6PM #6000



700ml Aluminum Cup
SST Fluid Joint
PCG7EM #6033E



1000ml Aluminum Cup
SST Fluid Joint
PCG10EM #6034E



with optional aluminum gravity feed cup

Classic plus Series



3M PPS Type 2

MODEL	GUN ONLY	600ml PLASTIC CUP	700ml ALUMINUM CUP	1000ml ALUMINUM CUP	NOZZLE mm (inch)	PSI	CFM	PATTERN WIDTH mm (inch)
LPH400-124LV	5540	5541	5542	5543	1.2 (0.047)	16	9.5	259 (10.2)
LPH400-134LV	5640	5641	5642	5643	1.3 (0.051)	16	9.5	279 (11.0)
LPH400-144LV	5550	5551	5552	5553	1.4 (0.055)	16	9.5	290 (11.4)
LPH400-154LV	5535	5536	5537	5538	1.5 (0.059)	16	9.5	295 (11.6)
LPH400-164LV	5560	5561	5562	5563	1.6 (0.063)	16	9.5	300 (11.8)
LPH400-184LV	5570	5571	5572	5573	1.8 (0.071)	16	9.5	320 (12.6)
LPH400-134LVX	5660	5661	5662	5663	1.3 (0.051)	16	9.8	300 (11.8)
LPH400-144LVX	5670	5671	5672	5673	1.4 (0.055)	16	9.8	310 (12.2)
LPH400-154LVX	5680	5681	5682	5683	1.5 (0.059)	16	9.8	330 (13.0)
LPH400-134LVB	5700	5701	5702	5703	1.3 (0.051)	14	8.3	320 (12.6)
LPH400-144LVB	5705	5706	5707	5708	1.4 (0.055)	14	8.3	325 (12.8)
LPH400-154LVB	5710	5711	5712	5713	1.5 (0.059)	14	8.3	335 (13.2)

PRIMER / SURFACER / SEALER

LPH300

Features

- Compact size and lighter weight reduces fatigue when spraying
- Full-size HVLP performance
- Unsurpassed in transfer efficiency for spraying primer and sealer
- Excellent for top coats, NGR stains, and industrial basecoats
- Produces an extremely smooth sealer finish to significantly reduce orange peel
- Flat, smooth fan pattern with a tight edge creates a soft transition edge when used for spot applications
- High transfer efficiency due to LV Technology means lower material cost per repair
- Compatible with the 3M PPS cup system (Adapter Type 43)
- Repair Service Kit Part #5650

with optional aluminum gravity feed cup



Optional
150ml Aluminum Cup
SST Fluid Joint
PCG2D-2 #6030D



400ml Aluminum Cup
SST Fluid Joint
PCG4D-2 #6031D



700ml Aluminum Cup
SST Fluid Joint
PCG7D-2 #6032D



MODEL	GUN ONLY	400ml ALUMINUM CUP	700ml ALUMINUM CUP	NOZZLE mm (inch)	PSI	CFM	PATTERN WIDTH mm (inch)	IDEAL FOR
LPH300-124LV	3940	3941	3942	1.2 (0.047)	15	7.1	210 (8.3)	Sealer and/or Wetbed
LPH300-134LV	3955	3956	3957	1.3 (0.051)	15	7.1	220 (8.7)	Sealer and/or Wetbed
LPH300-144LV	3945	3946	3947	1.4 (0.055)	15	7.1	230 (9.1)	Sealer and/or Wetbed
LPH300-164LV	3950	3951	3952	1.6 (0.063)	19	8.5	230 (9.1)	Surfacer/Primer
LPH300-184LV	3960	3961	3962	1.8 (0.063)	19	8.5	230 (9.1)	Surfacer/Primer
LPH300-204LV	3965	3966	3967	2.0 (0.079)	19	8.5	230 (9.1)	Surfacer/Primer

AIR GUNSA IMPACT AND HTE2/HV2

Features

- Robust spray gun
- Flat and thin spray pattern with a fine atomization
- All wetted parts in stainless steel
- Replacement parts available
- Compatible with the 3M PPS cup system (Type 43)
- O-Ring Kit Part #9131

Air-GunSA
ANEST IWATA Group



MODEL	GUN WITH 600ml PLASTIC CUP	NOZZLE mm (inch)	PSI	CFM	PATTERN WIDTH mm (inch)
IMPACT					
AZ3 HVLP-S 13	9270	1.3 (0.051)	28	10.83	280.0 (11.0)
AZ3 HVLP-S 14	9274	1.4 (0.055)	28	10.83	300.0 (11.8)
AZ3 HVLP-S 15	9271	1.5 (0.059)	28	10.83	320.0 (12.6)
AZ3 HVLP-S 16	9275	1.6 (0.063)	32	13.02	260.0 (10.2)
AZ3 HVLP-S 18	9272	1.8 (0.063)	32	13.02	280.0 (11.0)
AZ3 HVLP-S 20	9273	2.0 (0.079)	32	13.02	300.0 (11.8)

MODEL	GUN WITH 600ml PLASTIC CUP	NOZZLE mm (inch)	PSI	CFM	PATTERN WIDTH mm (inch)
HTE2					
AZ3HTE2	9234	1.3 (0.051)	29	7.0	241.3 (9.5)
AZ3HTE2	9235	1.5 (0.059)	29	7.0	254.0 (10)
AZ3HTE2	9236	1.8 (0.063)	29	7.5	304.8 (12)
AZ3HTE2	9237	2.0 (0.079)	29	7.5	342.9 (13.5)
AZ3HTE2	9238	3.0 (0.118)	44	10.5	406.4 (16)
AZ3HTE2	9239	3.5 (0.138)	44	10.5	419.1 (16.5)
HV2					
AZ3HV2-13GC	9230	1.3 (0.051)	28	11.0	304.8 (12)
AZ3HV2-15GC	9231	1.5 (0.059)	28	11.5	304.8 (12)
AZ3HV2-18GC	9232	1.8 (0.063)	28	13.5	304.8 (12)
AZ3HV2-20GC	9233	2.0 (0.079)	28	14.0	304.8 (12)

PRESSURE FEED SPRAY GUNS

LPH101-LV



Features

- Compact, lightweight pressure feed HVLP spray gun reduces fatigue while maintaining full size spray gun functionality
- LV Technology and tulip inspired spray pattern for superior atomization and minimal overspray for higher transfer efficiency
- Ideal for primer and DTM coatings
- Repair Service Kit Part #5650

Fluid Hose (white) #8009
Air Hose (yellow) #8002
Hoses are sold by the foot

1/4 inch fitting #8024
3/8 inch fitting #8023

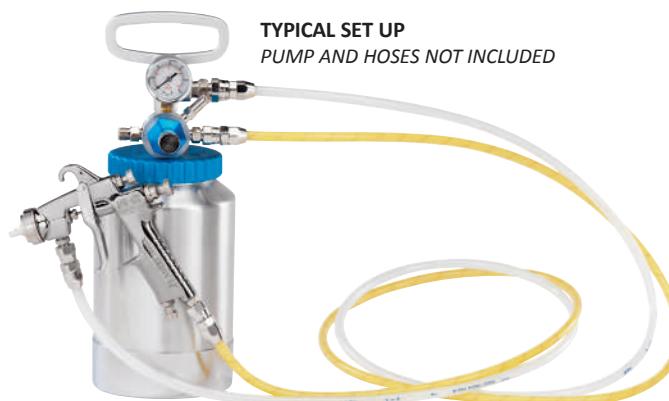

TYPICAL SET UP
PUMP AND HOSES NOT INCLUDED

MODEL	GUN ONLY	NOZZLE mm (inch)	PSI	CFM	PATTERN WIDTH mm (inch)
LPH101 PRESSURE					
LPH101-081P	5310B	0.8 (0.031)	38	15.2	279 (11.0)
LPH101-101P	5313B	1.0 (0.039)	38	15.2	290 (11.4)
LPH101-122P	5325B	1.2 (0.047)	50	18.7	295 (11.6)
LPH101-131P	5316B	1.3 (0.051)	38	15.2	300 (11.8)
LPH101-151P	5319B	1.5 (0.059)	38	15.2	320 (12.6)
LPH101-LV PRESSURE					
LPH101-062LVP	5334B	0.6 (0.024)	25	7.1	279 (11.0)
LPH100-082LVP	5331B	0.8 (0.031)	25	7.1	290 (11.4)
LPH100-102LVP	5332B	1.0 (0.039)	25	7.1	295 (11.6)
LPH101-112LVP	5335B	1.1 (0.043)	25	7.1	335 (13.2)

PRESSURE FEED SPRAY GUNS

LPH200-LV

Features

- Heavy-duty lightweight pressure feed HVLP spray gun is supplied with a standard spray set-up for industrial applications and higher viscosity materials
- Utilizing LV technology and tulip inspired spray pattern, allowing for superior atomization with minimal overspray
- Contact Anest Iwata for additional nozzle sizes and/or materials
- LPH200LV is Ideal for fine finishing, base, single stage, and clear
- LPH200 is ideal for primer and DTM coatings
- Repair Service Kit Part #5650

Fluid Hose (white) #8009

Air Hose (yellow) #8002

Hoses are sold by the foot

1/4 inch fitting #8024

3/8 inch fitting #8023

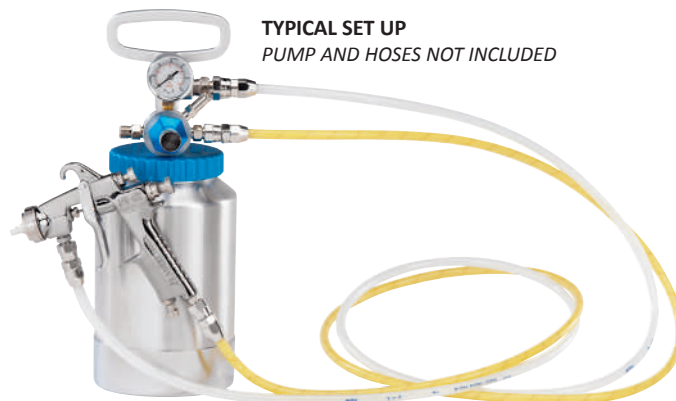

TYPICAL SET UP
PUMP AND HOSES NOT INCLUDED

MODEL	GUN ONLY	NOZZLE mm (inch)	PSI	CFM	PATTERN WIDTH mm (inch)
LPH200 PRESSURE					
LPH200-102P	5403	1.0 (0.039)	28	17.7	272 (10.7)
LPH200-122P	5400	1.2 (0.047)	28	17.7	300 (11.8)
LPH200-142P	5405	1.4 (0.055)	28	17.7	318 (12.5)
LPH200-LV PRESSURE					
LPH200-086LVP	5406	0.8 (0.031)	28	13.5	320 (12.6)
LPH200-106LVP	5407	1.0 (0.039)	28	13.5	330 (13.0)
LPH200-126LVP	5408	1.2 (0.047)	28	13.5	351 (13.8)

SMALL DAMAGE, MICRO REPAIR

LPH-80

Features

- Very fine atomization with low air consumption
- Extremely low material consumption
- Smaller pattern, perfect for touch up or small surface work
- Minimal wear parts for easy maintenance
- Compatible with the 3M PPS cup system (Adapter Type 31)
- Repair Service Kit Part #2860



with optional
aluminum
gravity feed cup



3M PPS Type 31



Optional
2oz Plastic Cup
SST Fluid Joint
#9169



150ml Aluminum Cup
SST Fluid Joint
PCG2D-1 #6036D

MODEL	GUN WITH 150ML ALUMINUM CUP	NOZZLE mm (inch)	PSI	CFM	PATTERN WIDTH mm (inch)
LPH80-042G	4901	0.4 (0.0)	13	1.8	41 (1.6)
LPH80-062G	4906	0.6 (0.0)	13	1.8	61 (2.4)
LPH80-082G	4911	0.8 (0.0)	13	1.8	81 (3.2)
LPH80-102G	4916	1.0 (0.039)	13	1.8	99 (3.9)
LPH80-122G	4921	1.2 (0.047)	13	1.8	119 (4.7)
LARGE PATTERN					
LPH80-104G	4926	1.0 (0.039)	14	2.1	130 (5.1)
LPH80-124G	4931	1.2 (0.047)	14	2.1	140 (5.5)

SMALL DAMAGE, MICRO REPAIR

LPH-50

Features

- High performance miniature HVLP spray gun with side mounted cup
- Superior atomization with low air consumption
- Repair Service Kit Part #2860



OPTIONAL

Airbrush Bottle Adapter Kit with Three
2oz. Bottles (Shown) Part #6022

Airbrush Bottle Adapter Only Part #6022-1



with optional
aluminum
gravity feed cup



130ml SST Cup
PC61 #6010



250ml Aluminum Cup
PC5 #6009

MODEL	GUN ONLY	130ml SST CUP	250ml ALUMINUM CUP	NOZZLE mm (inch)	PSI	CFM	PATTERN WIDTH mm (inch)
LPH50-042G	5261	5272	5271	0.4 (0.016)	13	1.8	41 (1.6)
LPH50-062G	5262	5274	5273	0.6 (0.024)	13	1.8	61 (2.4)
LPH50-102G	5263	5276	5275	1.0 (0.039)	13	1.8	99 (3.9)

SMALL DAMAGE, MICRO REPAIR

RG3L

Features

- Round pattern spray gun for touch-up and airbrushing
- Repair Service Kit Part #2860



with optional
aluminum
gravity feed cup



OPTIONAL

Airbrush Bottle Adapter Kit with Three
2oz. Bottles (Shown) Part #6022

Airbrush Bottle Adapter Only Part #6022-1



130ml SST Cup
PC61 #6010



250ml Aluminum Cup
PC5 #6009

MODEL	GUN ONLY	130ml SST CUP	250ml ALUMINUM CUP	NOZZLE mm (inch)	PSI	CFM	PATTERN WIDTH mm (inch)	NOTES
RG3L-1	2805	2862	2861	0.4 (0.016)	36	1.1	25 (1.0)	
RG3L-2	2806	2864	2863	0.6 (0.024)	36	1.1	36 (1.4)	
RG3L-3	2807	2866	2865	1.0 (0.039)	36	1.8	36 (1.4)	
RG3L-11	2808	2868	2867	0.4 (0.016)	36	1.1	25 (1.0)	With Air Adjust Set
RG3L-12	2809	2870	2869	0.6 (0.024)	36	1.1	36 (1.4)	With Air Adjust Set
RG3L-13	2810	2872	2871	1.0 (0.039)	36	1.8	36 (1.4)	With Air Adjust Set

PRESSURE POTS

2 GALLON PRESSURE POT

#6315

(max. 100 psi)

Features

- Paint pressure tank with stainless steel inner tank for easy filling and trouble-free interior cleaning
- Robust construction
- Suitable for hydraulic products
- Carry handle for quick and easy transport
- Equipped with locking lid, 2 controllers, 2 pressure gauges and safety valve
- Tank capacity: 10 liter, inner tank 8.5 liter stainless steel
- Air inlet joint: G 1/4" M
- Fluid output joint: 3/8" M
- Operating temperature: 5-40 .C
- Weight: 11kg
- Dimensions: 310x310x565mm



PC18D 2 QUART PRESSURE POT

#6003B

Also available in an agitated version

Features

- Small Paint Pressure Tank aluminum
- 2 liter
- Operating temperature: 5-40 .C
- Fluid Nipple: G 3/8" (PF3/8)



TYPICAL SET UP

Fluid Hose (white) #8009
Air Hose (yellow) #8002
Hoses are sold by the foot

1/4 inch fitting #8024
3/8 inch fitting #8023



Air/fluid hose optional lengths not shown
SPRAY GUN NOT INCLUDED

PUMPS

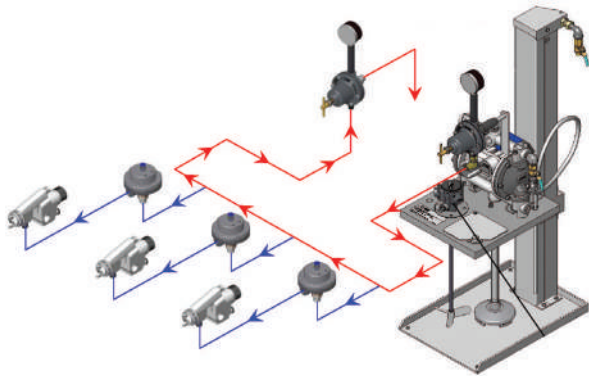

Multiple Gun Setup For Diaphragm Pump System
Operating multiple guns from one pump is achieved by adding PR-5B to individual gun paint supply.

DIAPHRAGM PUMP UNITS

Features

- Designed for production application environment
- Stainless steel fluid passages and fluid regulator - ideal for applications requiring waterborne or solvent borne materials
- Constant fluid output
- Diaphragm movement is minimal, reducing material supply pulsation and minimizing pump wear
- Easy Handling and Installation
- Fewer number of moving parts and simple construction assures easy maintenance



DPS901N Stainless Steel
Stand Mount #8096
21 x 21 x 40 in. - 35 lbs.



DPS902GN Stainless Steel
Pail Mount #8172
14 x 13 x 30 in. - 32 lbs.
(contact for availability)



DPS903GN Stainless Steel
Cart Mount #8173
20 x 21 x 40 in. - 40 lbs.

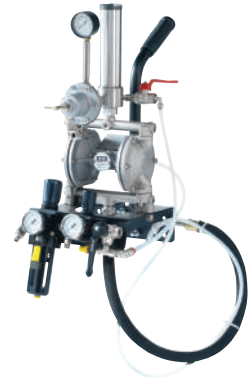

DPS904GN
Wall Mount #8174
11 x 12 x 23 in. - 29 lbs.

TYPICAL SET UP



Fluid Hose (white) #8009
Air Hose (yellow) #8002
Hoses are sold by the foot

*Air/fluid hose optional
lengths not shown
SPRAY GUN NOT
INCLUDED*

PUMP SPECIFICATIONS		PUMP SPECIFICATIONS	
Pump Model	DDP90DN	Pressure Ratio	1:1
Air Inlet	1/4" BSP	Maximum Fluid Pressure	98 psi
Air Outlet (Spray Gun)	1/4" BSP	Operating Air Pressure	20 - 98 psi
Fluid Outlet	3/8" BSP	Fluid Output/Cycle	1.70 oz
Fluid Filter	100 Mesh	Max. No. of Cycles	200 Cycles/min
Fluid Passage	Stainless Steel	Maximum Fluid Output	2.64 gal/min
Fluid Regulator Model	PR5N	Max. Fluid Viscosity	300 cps
Pressure Range	0-85 psi	Fluid Temperature (F)	41° - 109°
Max. Fluid Flow	0.53 gal/min	Air Inlet	1/4" BSP
Air Regulator	2 Air Regulators (pump / spray gun)	Fluid Inlet	1/2" BSP
Suction Tube	50 Mesh Inlet Filter and Circulation Tube	Fluid Outlet	3/8" BSP

ACCESSORIES



ADG-1 Aqua Dry Waterborne Paint Dryer

Gun only #7023

Stand with 2 guns #7076

Designed for flash acceleration of waterborne basecoat. Each gun includes air shut-off valves and has rotational adjustment for directing air in various positions. The guns can be disconnected from the stand for independent use, with two adjustment points, a butterfly valve at the air inlet and a 6:1 air volume adjustment ratio on the outlet gun nozzle.

MK-5 Professional Spray Gun Maintenance Kit #2950

The ideal accessory to ensure your spray gun maintains peak performance. Includes: Aircap cleaning pins & holder, large bottle brush, end brush and holder, five assorted detail bottle brushes down to 3/32", body brush.



Century Series Repair Service Kit #5650



Super Nova Repair Service Kit #5652



Spray Gun Lubricant (10 pcs/pck)

Part #8511



AK-1R2 Air Regulator

Part #8131B



AK-1B2 Air Regulator

Part # 8130B

SPRAY GUN CLEANING AND MAINTENANCE

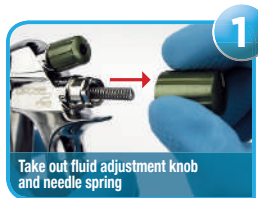

1 Take out fluid adjustment knob and needle spring



2 and also needle as well



3 take off the air cap



4 Unscrew fluid nozzle with spanner wrench*



1 Clean the material passage with brush



2 Clean the material passage with brush



3 Clean the body surface



4 Dry with air duster gun



1 Clean small holes on the fluid nozzle with a special tiny brush



2 and clean also nozzle orifice



3 Clean tip of the nozzle carefully with brush



4 Clean also thread of the nozzle carefully with brush



5 Clean the fluid nozzle internally with the correct size brush



1 Clean the air cap center hole



2 Clean tiny holes with needle



3 Clean horn holes with special tiny brush



4 and the back side as well



5 Clean needle



1 Assemble fluid nozzle



2 Tighten up the fluid nozzle with spanner wrench*



3 Assemble the air cap and hand-tighten it



4 Grease the needle



5 Insert the needle

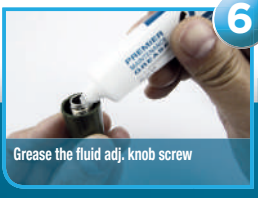

6 Grease the fluid adj. knob screw



7 Grease the needle spring



8 Grease the air valve bar behind the trigger



9 Adjust (15 - 60 degree tighten) needle packing with spanner universal



10 Check the trigger and needle travel smoothly



brush ϕ 3mm



brush ϕ 10mm



brush ϕ 15mm



lubricant

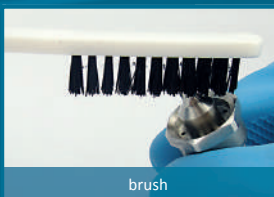

brush



needle

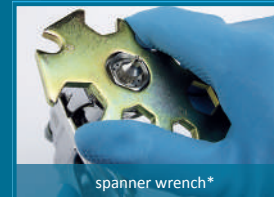

spanner wrench*

*Pictured: Anest Iwata Air Guns Spanner Wrench. Please use the appropriate spanner wrench provided in your product packaging for all repairs.

PART NUMBER QUICK REFERENCE

MODEL	GUN ONLY	400ml ALUMINUM CUP	600ml PLASTIC CUP	700ml ALUMINUM CUP	1000ml ALUMINUM CUP
WS400 EVOTECH					
WS400-1201 HD	5900	-	5901	5902	5903
WS400-OBS	5920	-	5921	5922	5923
WS400-1301 HD	5905	-	5906	5907	5908
WS400-1401 HD	5910	-	5911	5912	5913
WS400-1501 HD	5915	-	5916	5917	5918
W400-LV					
W400LV-124G	4750	-	4751	4752	4753
Compliant with AK-1R2	4855	-	4856	4857	4858
W400LV-134G	4755	-	4756	4757	4758
Compliant with AK-1R2	4860	-	4861	4862	4863
W400LV-144G	4760	-	4761	4762	4763
Compliant with AK-1R2	4865	-	4866	4867	4868
W400LV-164G	4765	-	4766	4767	4768
Compliant with AK-1R2	4870	-	4871	4872	4873
W400LV-184G	4770	-	4771	4772	4773
Compliant with AK-1R2	4875	-	4876	4877	4878
LS400 ENTECH					
LS400-1205	5930	-	5931	5932	5933
LS400-1305	5935	-	5936	5937	5938
LS400-1405	5940	-	5941	5942	5943
LS400-1505	5945	-	5946	5947	5948
LPH400-LV/LVX/LVB					
LPH400-124LV	5540	-	5541	5542	5543
LPH400-134LV	5640	-	5641	5642	5643
LPH400-144LV	5550	-	5551	5552	5553
LPH400-154LV	5535	-	5536	5537	5538
LPH400-164LV	5560	-	5561	5562	5563
LPH400-184LV	5570	-	5571	5572	5573
LPH400-134LVX	5660	-	5661	5662	5663
LPH400-144LVX	5670	-	5671	5672	5673
LPH400-154LVX	5680	-	5681	5682	5683
LPH400-134LVB	5700	-	5701	5702	5703
LPH400-144LVB	5705	-	5706	5707	5708
LPH400-154LVB	5710	-	5711	5712	5713
LPH300					
LPH300-124LV	3940	3941	-	3942	3943
LPH300-134LV	3955	3956	-	3957	3958
LPH300-144LV	3945	3946	-	3947	3948
LPH300-164LV	3950	3951	-	3952	3953
LPH300-184LV	3960	3961	-	3962	3963
LPH300-204LV	3965	3966	-	3967	3968
LPH200-LV					
LPH200-102P	5403	-	-	-	-
LPH200-122P	5400	-	-	-	-
LPH200-142P	5405	-	-	-	-
LPH200-086LVP	5406	-	-	-	-
LPH200-106LVP	5407	-	-	-	-
LPH200-126LVP	5408	-	-	-	-

MODEL	GUN ONLY	130ml SST CUP	GUN WITH 150ml ALUMINUM CUP	250ml ALUMINUM CUP	GUN WITH 600ml PLASTIC CUP
IMPACT					
AZ3 HVLP-S 13	-	-	-	-	9270
AZ3 HVLP-S 14	-	-	-	-	9274
AZ3 HVLP-S 15	-	-	-	-	9271
AZ3 HVLP-S 16	-	-	-	-	9275
AZ3 HVLP-S 18	-	-	-	-	9272
AZ3 HVLP-S 20	-	-	-	-	9273
HTE2					
AZ3HTE2	-	-	-	-	9234
AZ3HTE2	-	-	-	-	9235
AZ3HTE2	-	-	-	-	9236
AZ3HTE2	-	-	-	-	9237
AZ3HTE2	-	-	-	-	9238
AZ3HTE2	-	-	-	-	9239
AZ3HV2					
AZ3HV2-13GC	-	-	-	-	9230
AZ3HV2-15GC	-	-	-	-	9231
AZ3HV2-18GC	-	-	-	-	9232
AZ3HV2-20GC	-	-	-	-	9233
LPH101-LV					
LPH101-081P	5310B	-	-	-	-
LPH101-101P	5313B	-	-	-	-
LPH101-122P	5325B	-	-	-	-
LPH101-131P	5316B	-	-	-	-
LPH101-151P	5319B	-	-	-	-
LPH101-062LVP	5334B	-	-	-	-
LPH100-082LVP	5331B	-	-	-	-
LPH100-102LVP	5332B	-	-	-	-
LPH101-112LVP	5335B	-	-	-	-
LPH-80					
LPH80-042G	-	-	4901	-	-
LPH80-062G	-	-	4906	-	-
LPH80-082G	-	-	4911	-	-
LPH80-102G	-	-	4916	-	-
LPH80-122G	-	-	4921	-	-
LPH80-104G	-	-	4926	-	-
LPH80-124G	-	-	4931	-	-
LPH-50					
LPH50-042G	5261	5272	-	5271	-
LPH50-062G	5262	5274	-	5273	-
LPH50-102G	5263	5276	-	5275	-
RG3L					
RG3L-1	2805	2862	-	2861	-
RG3L-2	2806	2864	-	2863	-
RG3L-3	2807	2866	-	2865	-
RG3L-11	2808	2868	-	2867	-
RG3L-12	2809	2870	-	2869	-
RG3L-13	2810	2872	-	2871	-



Manual Spray Gun Catalog

Gravity Fed Spray Guns

From the development of our first spray gun in 1925 to our new Century Series, ANEST IWATA has been the pioneer in spray technology for over 75 years. ANEST IWATA's commitment to quality, innovation and service is unparalleled. Look to ANEST IWATA as the leader in the spray gun industry.

LPH400 LV

High performance center post gravity fed HVLP spray gun with low air consumption and superior atomization.



Model	Nozzle Size	Pattern Width (in.)	PSI	CFM	Gun Only #	PCG6PM #6000	PCG7DM #6033D	PCG10DM #6034D	M&S #6040	Usage	
LPH400-124LV	1.2	10.2	16	9.5	5540	5541	5542	5543	5549	Fine Metallic, Spot Repair, Light Industry, Hobby, Woodwork, Metal	
LPH400-134LV	1.3	11.0	16	9.5	5640	5641	5642	5643	5659	Base Coat, Clear Coat, Waterborne Base Coat, Woodwork, Metal	
LPH400-144LV	1.4	11.4	16	9.5	5550	5551	5552	5553	5559	Base Coat, Clear Coat, Single Stage, Woodwork, Metal	
LPH400-154LV	1.5	11.6	16	9.5	5535	5536	5537	5538	5539	Clear Coat, Single Stage, Medium to High Viscosity	
LPH400-164LV	1.6	11.8	16	9.5	5560	5561	5562	5563	5569	Sealers, Enamels, Medium to High Viscosity	
LPH400-184LV	1.8	12.6	16	9.5	5570	5571	5572	5573	5579	Primers, High Viscosity	
Air Cap Test Gauge			Air Cap #LPH400-LV4			Part #2995		Air Inlet 1/4"		Fluid Inlet M16 x 1.5	

LPH400 LVX

Designed to increase productivity for 0 to 95% of all basecoats.



Model	Nozzle Size	Pattern Width (in.)	PSI	CFM	Gun Only #	PCG6PM #6000	PCG7DM #6033D	PCG10DM #6034D	M&S #6040	Usage	
LPH400-134LVX	1.3	11.8	16	9.8	5660	5661	5662	5663	5664	Basecoat, Metallic & Pearls	
LPH400-144LVX	1.4	12.2	16	9.8	5670	5671	5672	5673	5674	Basecoat, Metallic & Pearls	
LPH400-154LVX	1.5	13.0	16	9.8	5680	5681	5682	5683	5684	Basecoat, Metallic & Pearls	
Air Cap Test Gauge			Air Cap #LPH400-LVX			Part #2998		Air Inlet 1/4"		Fluid Inlet M16 x 1.5	



LPH400 LVB

Designed with excellent metallic control for the most difficult basecoats.



Model	Nozzle Size	Pattern Width (in.)	PSI	CFM	Gun Only #	PCG6PM #6000	PCG7DM #6033D	PCG10DM #6034D	M&S #6040	Usage	
LPH400-134LVB	1.3	12.6	14	8.3	5700	5701	5702	5703	5704	Fine Metallic	
LPH400-144LVB	1.4	12.8	14	8.3	5705	5706	5707	5708	5709	Fine Metallic	
LPH400-154LVB	1.5	13.2	14	8.3	5710	5711	5712	5713	5714	Fine Metallic	
Air Cap Test Gauge			Air Cap #LPH400-LVB			Part #2996		Air Inlet 1/4"		Fluid Inlet M16 x 1.5	



LPH300 LV

Compact size center post gravity fed HVLP spray gun with full size performance.



Model	Nozzle Size	Pattern Width (in.)	PSI	CFM	Gun Only #	PCG7D2 #603D	M&S #6041	Usage	
LPH300-124LV	1.2	8.0	15	7.1	3940	3942	3943	Spot Repair, Light Industry, Hobby, Woodwork, Metal	
LPH300-134LV	1.3	8.5	15	7.1	3955	3957	3958	Base Coat, Woodwork, Metal	
LPH300-144LV	1.4	9.0	15	7.1	3945	3947	3948	Base Coat, Clear Coat, Woodwork, Metal	
LPH300-164LV	1.6	9.0	19	8.5	3950	3952	3953	Sealers, Medium to High Viscosity	
LPH300-184LV	1.8	9.0	19	8.5	3960	3962	3963	Primers, Medium to High Viscosity	
LPH300-204LV	2.0	9.0	19	8.5	3965	3967	3968	HS Primer, High Viscosity	
Air Cap Test Gauge			Air Cap #LPH100-LV4			Part #2985B		Air Inlet 1/4" Fluid Inlet 1/4" Female	

LPH440

Designed specifically for spraying primers, sealers and fillers. The sharp edged spray pattern of the LPH440 creates optimal overlap increasing working speed.



M&S Cup #6040
Reusable/Disposable Cup



PCG6PM #6000
600ml Plastic Cup



PCG7DM #6033D
700ml Aluminum Cup
SST Fluid Joint



PCG10DM #6034D
1000ml Aluminum Cup
SST Fluid Joint



Model	Nozzle Size	Pattern Width (in.)	PSI	CFM	Gun Only #	PCG6PM #6000	PCG7DM #6033D	PCG10DM #6034D	M&S #6040	Usage
PH440-141	1.4	9.8	20	8.9	5720	5721	5722	5723	5724	Primers / Sealers
PH440-161	1.6	10.2	20	8.9	5725	5726	5727	5728	5729	Primers / Sealers
PH440-181	1.8	10.6	20	8.9	5730	5731	5732	5733	5734	Primers / Sealers
PH440-201	2.0	11.0	20	8.9	5735	5736	5737	5738	5739	Primer Surfacer
PH440-251	2.5	11.4	20	8.9	5740	5741	5742	5743	5744	Polysurfacer
Air Cap Test Gauge		Air Cap #H440	Part #997		Air Inlet 1/4"		Fluid Inlet M16 x 1.5			

W400-LV Compliant

Center post gravity fed spray gun combines LV Technology with High-TEC standard to give you high transfer efficiency control and superior atomization.



M&S Cup #6040
Reusable/Disposable Cup



PCG6PM #6000
600ml Plastic Cup



PCG7DM #6033D
700ml Aluminum Cup
SST Fluid Joint



PCG10DM #6034D
1000ml Aluminum Cup
SST Fluid Joint



Model	Nozzle Size	Pattern Width (in.)	PSI	CFM	Gun Only #	PCG6PM #6000	PCG7DM #6033D	PCG10DM #6034D	M&S #6040	Usage
W400LV-124G with AK-1B	1.2	9.6	20	10.0	4750	4751	4752	4753	4754	Base Coat, Clear Coat, Spot Repair, Fine Metallic, Waterborne, Light Industry, Hobby
					4830	4831	4832	4833	4834	
W400LV-134G with AK-1B	1.3	10.2	20	10.0	4755	4756	4757	4758	4759	Base Coat, Clear Coat, Touch-Ups, Waterborne, Woodwork, Metal
					4835	4836	4837	4838	4839	
W400LV-144G with AK-1B	1.4	10.8	20	10.0	4760	4761	4762	4763	4764	Base Coat, Clear Coat, Touch-Ups, Waterborne, Woodwork, Metal
					4840	4841	4842	4843	4844	
W400LV-164G with AK-1B	1.6	11.2	20	10.0	4765	4766	4767	4768	4769	Clear, Medium to High Viscosity
					4845	4846	4847	4848	4849	
W400LV-184G with AK-1B	1.8	11.8	20	10.0	4770	4771	4772	4773	4774	Primer, High Viscosity
					4850	4851	4852	4853	4854	
					Air Inlet 1/4"		Fluid Inlet M16 x 1.5			



W400

Center post gravity fed spray gun with high transfer efficiency control and superior atomization.



M&S Cup #6040
Reusable/Disposable Cup



PCG6PM #6000
600ml Plastic Cup



PCG7DM #6033D
700ml Aluminum Cup
SST Fluid Joint



PCG10DM #6034D
1000ml Aluminum Cup
SST Fluid Joint



Model	Nozzle Size	Pattern Width (in.)	PSI	CFM	Gun Only #	PCG6PM #6000	PCG7DM #6033D	PCG10DM #6034D	M&S #6040	Usage
W400-122G	1.2	9.1	29	9.9	4700	4702	4702T	4702U	4704	Fine Metallics, Woodwork, Metal
W400-132G	1.3	10.2	29	9.9	4725	4727	4727T	4727U	4729	Base Coat, Clear Coat, Woodwork, Metal
W400-142G	1.4	11.0	29	9.9	4705	4707	4707T	4707U	4709	Base Coat, Clear Coat, Single Stage, Woodwork, Metal
W400-162G	1.6	11.8	29	9.9	4710	4712	4712T	4712U	4714	Enamels, Woodwork, Metal
W400-182G	1.8	11.9	29	10.2	4715	4717	4717T	4717U	4719	Sealers, Medium to High Viscosity
W400-251G	2.5	13.4	43	12.7	4720	4722	4722T	4722U	4724	HS Primer, High Viscosity
					Air Inlet 1/4"		Fluid Inlet M16 x 1.5			

Pressure and Siphon Fed Spray Guns

LPH200P / LPH200 LVP

High performance and lightweight pressure fed HVLP spray gun.



Model	Nozzle Size	Pattern Width (in.)	PSI	CFM	Gun Only #	Usage
LPH200 Pressure						
LPH200-102P	1.0	10.7	28	17.7	5403	HS 2.8 - 3.5 voc / Large Work pieces, Woodwork, Fleet Vehicles
LPH200-122P	1.2	11.8	28	17.7	5400	5.0 voc / Large Work pieces, Woodwork, Fleet Vehicles
LPH200-142P	1.4	12.5	28	17.7	5405	Enamels, Large Work pieces, Woodwork, Fleet Vehicles
LPH200 LV Pressure						
LPH200-086LVP	0.8	12.6	28	13.5	5406	High Metallic 2.8 - 3.5 voc / Large Work pieces, Woodwork, Fleet Vehicles
LPH200-106LVP	1.0	13.0	28	13.5	5407	HS 2.8 - 3.5 voc / Large Work pieces, Woodwork, Fleet Vehicles
LPH200-126LVP	1.2	13.8	28	13.5	5408	Enamels 3.5 - 5.0 voc / Primers, Large Work pieces, Woodwork, Fleet Vehicles
			Air inlet 1/4" Fluid Inlet 3/8"			
		LPH200-P	Air Cap Test Gauge	Air Cap #LPH200-G2	Part #2991	
		LPH200-LVP	Air Cap Test Gauge	Air Cap #LPH200-LV6	Part #2992	

LPH101P / LPH100 LVP

High performance, compact and lightweight pressure fed HVLP spray gun.



Model	Nozzle Size	Pattern Width (in.)	PSI	CFM	Gun Only #	Usage
LPH101 Pressure						
LPH101-081P	0.8	6.7	38	15.2	5310B	High Metallic 2.8 - 3.5 voc / Spot Repair, Light Industry
LPH101-101P	1.0	7.9	38	15.2	5313B	HS 3.5 voc / Woodwork, Metal
LPH101-122P	1.2	10.6	50	18.7	5325B	Enamels 3.5 - 5.0 voc / Woodwork, Metal
LPH101-131P	1.3	9.4	38	15.2	5316B	Enamels 5.0 voc / Woodwork, Metal
LPH101-151P	1.5	9.8	38	15.2	5319B	Primers, Single Stage, Med to High Viscosity, Woodwork, Metal
LPH100 LV Pressure						
LPH100-082LVP	0.8	9.1	25	7.1	5331	High Metallic, Fleet Vehicles, Woodworking (NGR Stains/Toners)
LPH100-102LVP	1.0	9.8	25	7.1	5332	High Metallic, Fleet Vehicles, Woodworking (NGR Stains/Toners)
		LPH101-P	Air Cap Test Gauge	Air Cap #LPH101-G2	Part #2986B Use With #5325B Only	
		LPH101-P	Air Cap Test Gauge	Air Cap #LPH101-E1	Part #2987B	
		LPH100-LVP	Air Cap Test Gauge	Air Cap #LPH100-LV6	Part #2968	

LPH101 LVS

High performance, compact and lightweight siphon fed HVLP spray gun.



PCL 7B2 #6019
700ml Aluminum

PCL 10B2 #6015
1000ml Aluminum

Model	Nozzle Size	Pattern Width (in.)	PSI	CFM	Gun Only #	PCL 7B2 #6019	PCL 10B2 #6015	Usage
LPH101-144LVS	1.4	7.1	14	7.0	5375B	5376B	5377B	Base Coat, Clear Coat, Touch-ups, Woodwork, Metal
LPH101-164LVS	1.6	7.5	14	7.0	5385B	5386B	5387B	Enamels, Med to High Viscosity, Woodwork, Metal
			Air Cap Test Gauge		Air Cap #LPH101-LV4		Part #2985B Air Inlet 1/4" Fluid Inlet 1/4"	



W200P / W200S

A lightweight gun with high transfer efficiency control. Available in pressure or siphon fed models.

PCL 7B3 #6021
700ml Aluminum
W200S ONLY

PCL 10B3 #6017
1000ml Aluminum
W200S ONLY

Model	Nozzle Size	Pattern Width (in.)	PSI	CFM	Gun Only #	PCL 7B3 #6021	PCL 10B3 #6017	Usage
W200 Pressure								
W200-122P	1.2	15.7	42	19.8	4600	n/a	n/a	Base Coat, Clear Coat, Large Work Pieces, Line Painting, Woodwork, Metal
					Air Inlet 1/4" Fluid Inlet 3/8"			
W200 Siphon								
W200-152S	1.5	11.4	42	11.7	4615	4616	4617	Base Coat, Clear Coat, Woodwork, Metal
W200-182S	1.8	13.4	42	11.7	4625	4626	4627	Enamels, Woodwork, Metal
W200-201S	2.0	10.2	42	9.2	4630	4631	4632	Sealers, Woodwork, Metal
W200-202S	2.0	11.4	42	12.7	4640	4641	4642	Primers, Med to High Viscosity, Woodwork, Metal
W200-251S	2.5	11.0	42	12.7	4650	4651	4652	Primers, Med to High Viscosity, Woodwork, Metal Adhesives, Anti-Corrosion
					Air Inlet 1/4" Fluid Inlet 3/8"			



PCL 7B2 #6019
700ml Aluminum
W101S ONLY



PCL 10B2 #6015
1000ml Aluminum
W101S ONLY

W101P / W101S

A compact gun with high transfer efficiency control. Available in pressure or siphon fed models.



Model	Nozzle Size	Pattern Width (in.)	PSI	CFM	Gun Only #	PCL 7B2 #6019	PCL 10B2 #6015	Usage
W101 Pressure								
W101-082P	0.8	7.5	35	9.5	4400B	n/a	n/a	High Metallics, Woodwork, Metal, Plastic
W101-102P	1.0	8.7	35	9.5	4403B	n/a	n/a	HS Top Coat, Woodwork, Metal, Plastic
W101-132P	1.3	8.3	35	7.8	4405B	n/a	n/a	Enamels, Med to High Viscosity, Woodwork, Metal, Plastic
W101-152P	1.5	9.4	35	7.8	4407B	n/a	n/a	Primers, Med to High Viscosity, Woodwork, Metal, Plastic
					Air Inlet 1/4" Fluid Inlet 3/8"			
W101 Siphon								
W101-101S	1.0	4.7	35	2.6	4420B	4421B	4422B	Top Coat, Woodwork, Metal, Plastic
W101-132S	1.3	6.3	35	7.9	4430B	4431B	4432B	Top Coat, Woodwork, Metal, Plastic
W101-134S	1.3	8.1	28	7.4	4580B	4581B	4582B	Top Coat, Woodwork, Metal, Plastic
W101-152S	1.5	6.9	35	7.9	4440B	4441B	4442B	Sealers, Med to High Viscosity, Woodwork, Metal, Plastic
W101-181S	1.8	6.7	35	5.3	4445B	4446B	4447B	Primers, Med to High Viscosity, Woodwork, Metal, Plastic
					Air Inlet 1/4" Fluid Inlet 1/4"			

PRESSURE POT

The PC18D 2 Quart Pressure Pot is versatile and mobile. This pressure pot may be used with any of our pressure fed spray guns.

Model	Part #
PC18D 2 Quart Pressure Pot	6003B
Air / Fluid Hoses	
6f Air Hose w/ends 1/4 x1/4	8000
6f Fluid Hose w/ends 3/8 x3/8	8007
Optional 6f Fluid Hose w/ends 1/4 x3/8	8044
Air Inlet / Outlet 1/4" Fluid Outlet 3/8"	

Air / fluid hose optional lengths not shown.
GUN NOT INCLUDED.

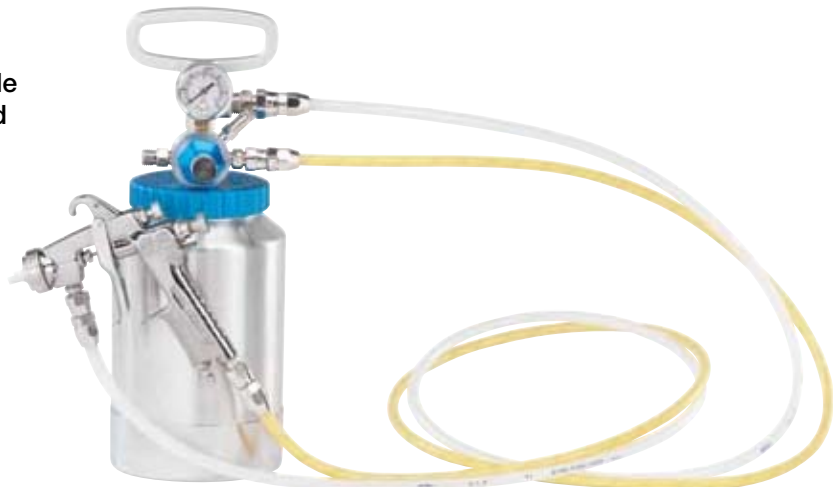

Specialty



PC4S #6008
400ml Aluminum Cup



PCG6P2 #6011
600ml Plastic Cup



PC61 #6010
130ml SST Cup



PC5 #6009
250ml Aluminum Cup

LPH101 LVG

High performance compact HVLP spray gun with side mounted gravity cup and low air consumption.

Model	Nozzle Size	Pattern Width (in.)	PSI	CFM	Gun Only #	PCG6P2 #6011	PC4S #6008	Usage
LPH101-124LVG	1.2	7.1	14	7.1	5360B	5361B	5362B	Fine Metallics, Spot Repair, Light Industry, Hobby
LPH101-144LVG	1.4	8.7	14	7.1	5370B	5371B	5372B	Base Coat, Clear Coat, Single Stage, Woodwork, Metal
LPH101-164LVG	1.6	8.7	18	8.5	5380B	5381B	5382B	Sealer, Woodwork, Metal
LPH101-184LVG	1.8	8.7	18	8.5	5390B	5391B	5392B	Primers, Med to High Viscosity
Air Cap Test Gauge			Air Cap #LPH101-LV4		Part #2985B		Air Inlet 1/4" Fluid Inlet 1/4"	



LPH101 shown with #6022
airbrush bottle adapter kit



LPH50

A high performance miniature HVLP spray gun with side mounted cup. Superior atomization with low air consumption.

Model	Nozzle Size	Pattern Width (in.)	PSI	CFM	Gun Only #	PC5 #6009	PC61 #6010	Usage
LPH50-042G	0.4	1.6	13	1.8	5261	5271	5272	Spot Repair, Graphics, Woodwork, Hobby (Touch-ups, Shading)
LPH50-062G	0.6	2.4	13	1.8	5262	5273	5274	Spot Repair, Graphics, Woodwork, Hobby (Touch-ups, Shading)
LPH50-102G	1.0	3.9	13	1.8	5263	5275	5276	Spot Repair, Graphics, Woodwork, Hobby (Touch-ups, Shading)
Air Cap Test Gauge			Air Cap #LPH50-E2		Part #2981		Air Inlet 1/4" Fluid Inlet 1/4"	
Airbrush Bottle Adapter Kit with Three 2oz. Bottles			Airbrush Bottle Adapter Only		Repair Service Kit		Part #6022 Part #6022-1 Part #2860	

LPH80

LPH80 HVLP miniature center post spray gun is ideal for large backgrounds, spot repair, blending, shading and touch-up. Spray patterns ranging from 1.6 inch round pattern to a full 5.5 inch fan pattern.

Model	Nozzle Size	Pattern Width (in.)	PSI	CFM	Gun Only #	PCG2D-1 #6036D	Usage
LPH80-042G	0.4	1.6	13	1.8	4900	4901	Spot Repair, Graphics, Woodwork Hobby (Touch-ups, Shading)
LPH80-062G	0.6	2.4	13	1.8	4905	4906	Spot Repair, Graphics, Woodwork Hobby (Touch-ups, Shading)
LPH80-082G	0.8	3.2	13	1.8	4910	4911	Spot Repair, Graphics, Woodwork Hobby (Touch-ups, Shading)
LPH80-102G	1.0	3.9	13	1.8	4915	4916	Spot Repair, Graphics, Woodwork Hobby (Touch-ups, Shading)
LPH80-122G	1.2	4.7	13	1.8	4920	4921	Spot Repair, Graphics, Woodwork Hobby (Touch-ups, Shading)
Large Pattern							
LPH80-104G	1.0	5.1	14	2.1	4925	4926	Spot Repair, Graphics, Woodwork Hobby (Touch-ups, Shading)
LPH80-124G	1.2	5.5	14	2.1	4930	4931	Spot Repair, Graphics, Woodwork Hobby (Touch-ups, Shading)
Air Inlet: 1/4"			Fluid Inlet: 3/8"				
LPH50	Air Cap Test Gauge	Air Cap #LPH50-E2	Part #2981				
LPH80	Air Cap Test Gauge	Air Cap #LPH80-E4	Part #2982				



PCG2D-1 #6036D
150ml Aluminum
SST Fluid Joint



Optional #9169
2oz. Plastic
SST Fluid Joint



PC5 #6009
250ml Aluminum Cup



PC4S #6008
400ml Aluminum Cup

W101G

The W101G is a versatile spray gun with a side mounted cup and high transfer efficiency.

Model	Nozzle Size	Pattern Width (in.)	PSI	CFM	Gun Only #	PC4S #6008	PC5 #6009	Usage
W101-101G	1.0	5.1	35	2.6	4450B	4451B	4452B	Touch-up, Spot Repair, Woodwork, Metal, Plastic
W101-132G	1.3	6.9	35	7.9	4560B	4561B	4562B	Fine Metallics, Spot Repair, Woodwork, Metal, Plastic
W101-134G	1.3	8.1	28	7.4	4585B	4586B	4587B	Base Coat, Med Viscosity, Woodwork, Metal, Plastic
W101-152G	1.5	7.5	35	7.9	4570B	4571B	4572B	Base Coat, Clear Coat, Woodwork, Metal, Plastic
W101-181G	1.8	7.5	35	5.3	4575B	4576B	4577B	Primers, Sealers, Woodwork, Metal, Plastic
Air Inlet 1/4"			Fluid Inlet 1/4"					



RG3L

A round pattern spray gun for touch-up and airbrushing.



Model	Nozzle Size	Pattern Width (in.)	PSI	CFM	Gun Only #	PC61 #6010	PC5 #6009	Note
RG3L-1	0.4	1.0	36	1.1	2805	2862	2861	
RG3L-2	0.6	1.4	36	1.1	2806	2864	2863	
RG3L-3	1.0	1.4	36	1.8	2807	2866	2865	
RG3L-11	0.4	1.0	36	1.1	2808	2868	2867	With Air Adjust Set
RG3L-12	0.6	1.4	36	1.1	2809	2870	2869	With Air Adjust Set
RG3L-13	1.0	1.4	36	1.8	2810	2872	2871	With Air Adjust Set
Air Inlet 1/4" Fluid Inlet 1/4"								
Airhub Bttle Adpiter K with Three 20Bttles						R 0022		
Airhub Bttle Adpiter Oly						R 0022-1		
Bpir Serie K						R 2860		



W101A

A specialty gun with an air driven agitated cup used for pearls, metallic and other specialty coatings that rapidly settle

Model	Nozzle Size	Pattern Width (in.)	PSI	CFM	Complete Kit
W101A Gravity					
W101A-104G	1.0	6.5	21-29	6.4	4590B with 400ml Cup
W101A-134G	1.3	7.1	21-29	6.4	4588B with 400ml Cup
W101A Siphon					
W101A-134S	1.3	6.7	21-29	6.4	4589B with 600ml Cup
Air Inlet 1/4"			Fluid Inlet 1/4"		



Spray Gun Lubricant

(10 pcs/pck)
Part #8511



5650 Century Series Repair Service Kit



8018 Regulator

Compact regulator with gauge.



Century Gun Color Identification Caps

Part #93710530



ADG-1 Aqua Dry Waterborne Paint Dryer Gun Only (Part #7023) Stand With 2 Guns (Part #7031)

Designed for flash acceleration of waterborne basecoat. Includes air shut-off valve. Two extendable arms have rotational adjustment for directing air in various positions and the guns can be disconnected form stand for independent use. With two adjustment points a butterfly valve at the air inlet and a 6:1 air volume adjustment ratio on the outlet gun nozzle.



MK-5 Professional Spray Gun Maintenance Kit

The ideal accessory to ensure your spray gun maintains peak performance. Includes: Aircap cleaning pins & holder, large bottle brush, end brush and holder, five assorted detail bottle brushes down to 3/32", body brush.
Part #2950



8130 AK-1B Air Flow Control Valve

Exclusive "swing & swivel" design for improved handling of bulky air hose. Simple air adjusting knob design ensures durability with precise air inlet pressure adjusting.